

Walter House

From: Workman, Liz S <lworkman@ncdot.gov>
Sent: Wednesday, August 12, 2020 1:12 PM
To: William F Ward
Cc: Walter House
Subject: RE: [External] R-4463A status

Mr. Ward,

Here is a snippet from the latest design plan for your parcel. You will see a driveway cut near the vet property and the PUE for the school's entrance was changed to ROW. Although our plans are at 100% design, there could be some changes in the future, especially if time passes and new issues arise. I imagine any changes at this point would be minor in nature though. Feel free to pass this design to your prospective buyers with the caveat that it is subject to change. And you can give my contact information for additional questions. Hope that this helps!
Good luck with everything.

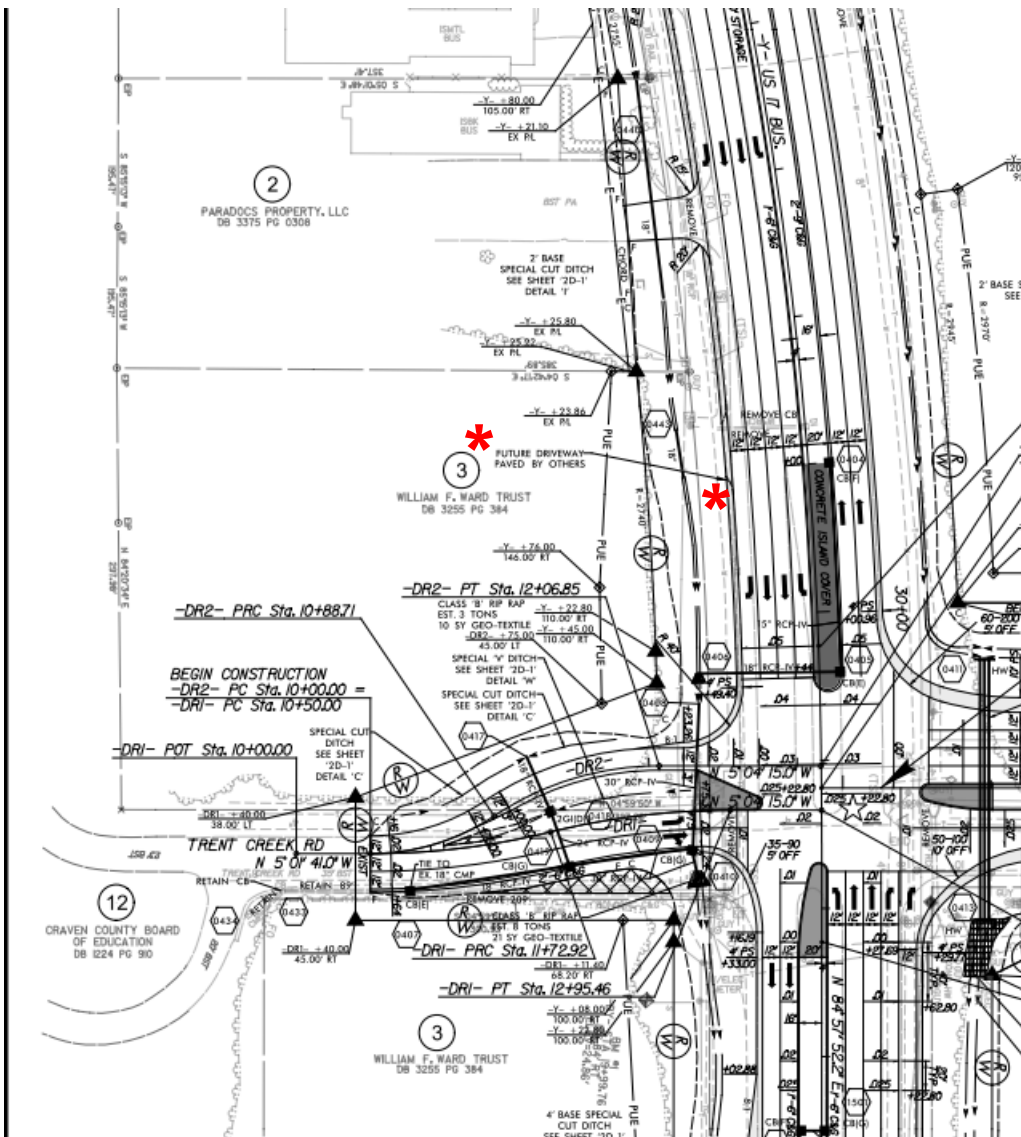

Sincerely,
Liz

Elizabeth Workman-Maurer
Division 2 Project Manager

252 439 2824 office
919 854 6221 direct
lsworkman@ncdot.gov

NCDOT Division 2
Project Development
1037 W. H. Smith Blvd.
Greenville, NC 27835



Email correspondence to and from this address is subject to the North Carolina Public Records Law and may be disclosed to third parties.

[Facebook](#) [Twitter](#) [YouTube](#)

From: William F Ward <wward@ncdot.gov>
Sent: Wednesday, August 12, 2020 10:32 AM
To: Workman, Liz S <lsworkman@ncdot.gov>
Cc: William F Ward <wward@ncdot.gov>
Subject: RE: [External] R-4463A status

CAUTION: External email. Do not click links or open attachments unless you verify. Send all suspicious email as an attachment to report.spam@nc.gov

Liz,
We are selling our tracts as you know. I had wanted to finalize the DOT stuff before we sold it. We tried but... My question is what do I tell the prospective purchasers as to the potential impact? I am sharing the drawings and the diagrams that Bob Chadwich made for discussion. I have had a forestry mower go out and cut the undergrowth to the PUE stakes on my corner lot. That is the area that you verbally stated would be changed to ROW as it would contain the actual road into the school. Also, the verbal agreement as to the curbcut on the lot next to the vet's property has not been documented. Can you give me anything IN WRITING that I may share with the auctioneer and prospective buyers which would be informative? Or, is the design likely to be changed further?

Thanks Liz. You guys, hopefully, will be dealing with someone other than me as we hope this will close out in September.

Bill

From: Workman, Liz S [<mailto:lsworkman@ncdot.gov>]
Sent: Wednesday, August 12, 2020 9:57 AM
To: William F Ward
Subject: RE: [External] R-4463A status

Dear Mr. Ward,

I received your phone message yesterday regarding R-4463A. At this time, the project has been pushed back to LET in December. The ROW acquisition has completely stopped though; so I wonder if that will impact the December LET date. You may have heard in the news, NCDOT is having financial issues. Most of our projects came to an immediate stop. I wish that I had better news for you. If you have any other questions, please feel free to ask. I am working from home these days so email is the fastest way to reach me.
Have a great day!
Liz

Elizabeth Workman-Maurer
Division 2 Project Manager

252 439 2824 office
919 854 6221 direct
lsworkman@ncdot.gov

NCDOT Division 2
Project Development
1037 W. H. Smith Blvd.
Greenville, NC 27835



Email correspondence to and from this address is subject to the North Carolina Public Records Law and may be disclosed to third parties.

[Facebook](#) [Twitter](#) [YouTube](#)

From: William F Ward <william.f.ward@ncdot.gov>
Sent: Monday, June 22, 2020 5:25 PM
To: Workman, Liz S <lsworkman@ncdot.gov>
Cc: 'Betsy Hagan (Ward)' <bhagan34@cox.net>; 'Audrey Ward' <audreyward@gmail.com>; 'Martha Garbano' <martha.garbano@ncdot.gov>; 'William F Ward' <william.f.ward@ncdot.gov>
Subject: [External] R-4463A status

CAUTION: External email. Do not click links or open attachments unless you verify. Send all suspicious email as an attachment to report.spam@nc.gov

Dear Liz,
I emailed Michael Harper with the City of New Bern today to check on the clearing of the ROW for the connector on our properties. He informed me that the project is on hold. Please verify and clarify what the timelines are for the ROW acquisition resolution and the time for the beginning of construction. We want to proceed with the marketing of our property and its sale.

Please advise asap so we can plan accordingly. Thanks so much.

Bill Ward

Email correspondence to and from this sender is subject to the N.C. Public Records Law and may be disclosed to third parties.

Plan Sheet 4

Note Drive Cut

PUE

Prop R/W

Prop R/W

PUE

MATCHLINE -Y- STA. 33+70. SEE SHEET 15

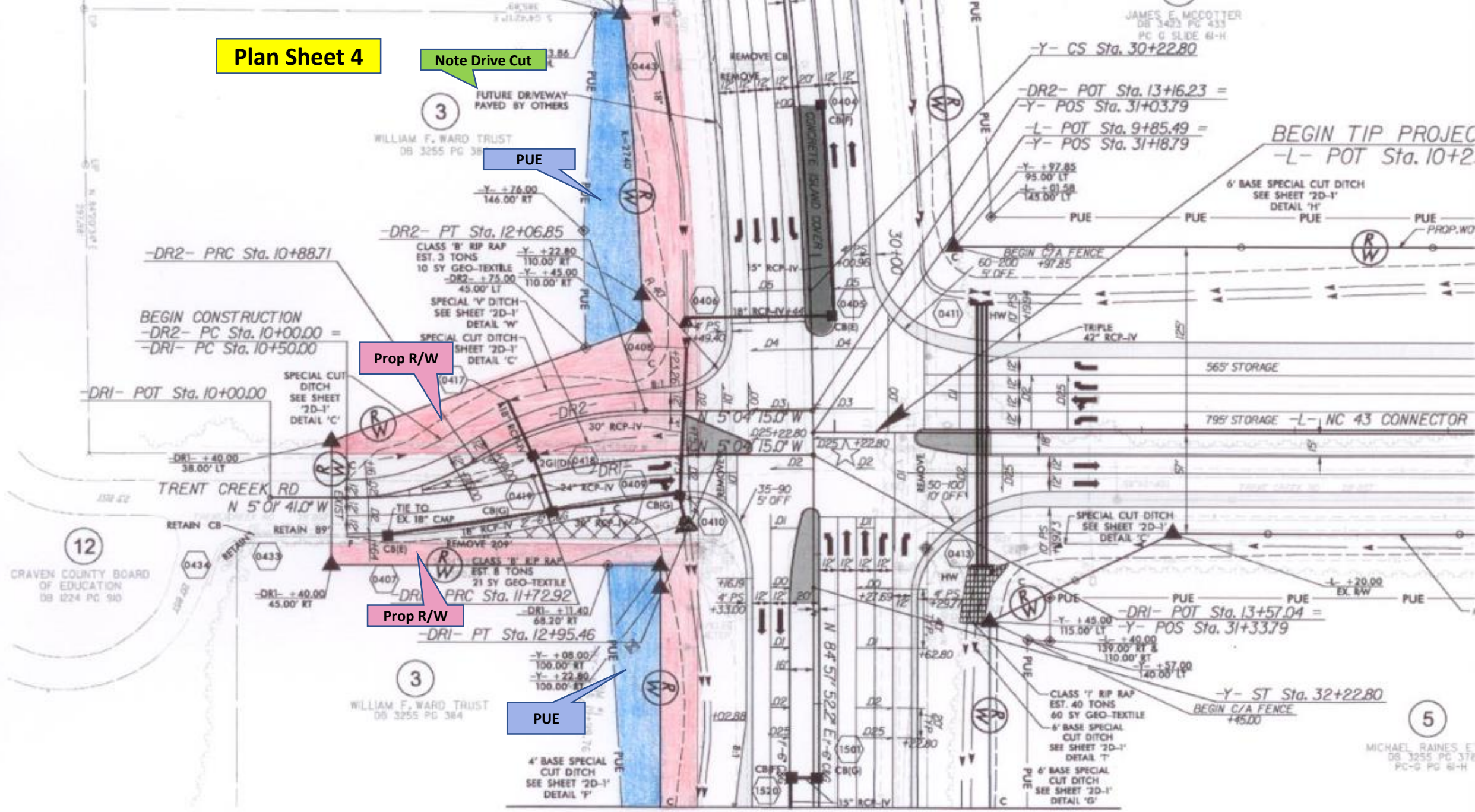

JAMES E. MCCOTTER
DB 3433 PG 433
PC G SLIDE 6I-H

MICHAEL RAINES E
DB 3255 PG 378
PC-G PG 6I-H

Plan Sheet 15

MATCHLINE -Y- STA. 33+70, SEE SHEET 4

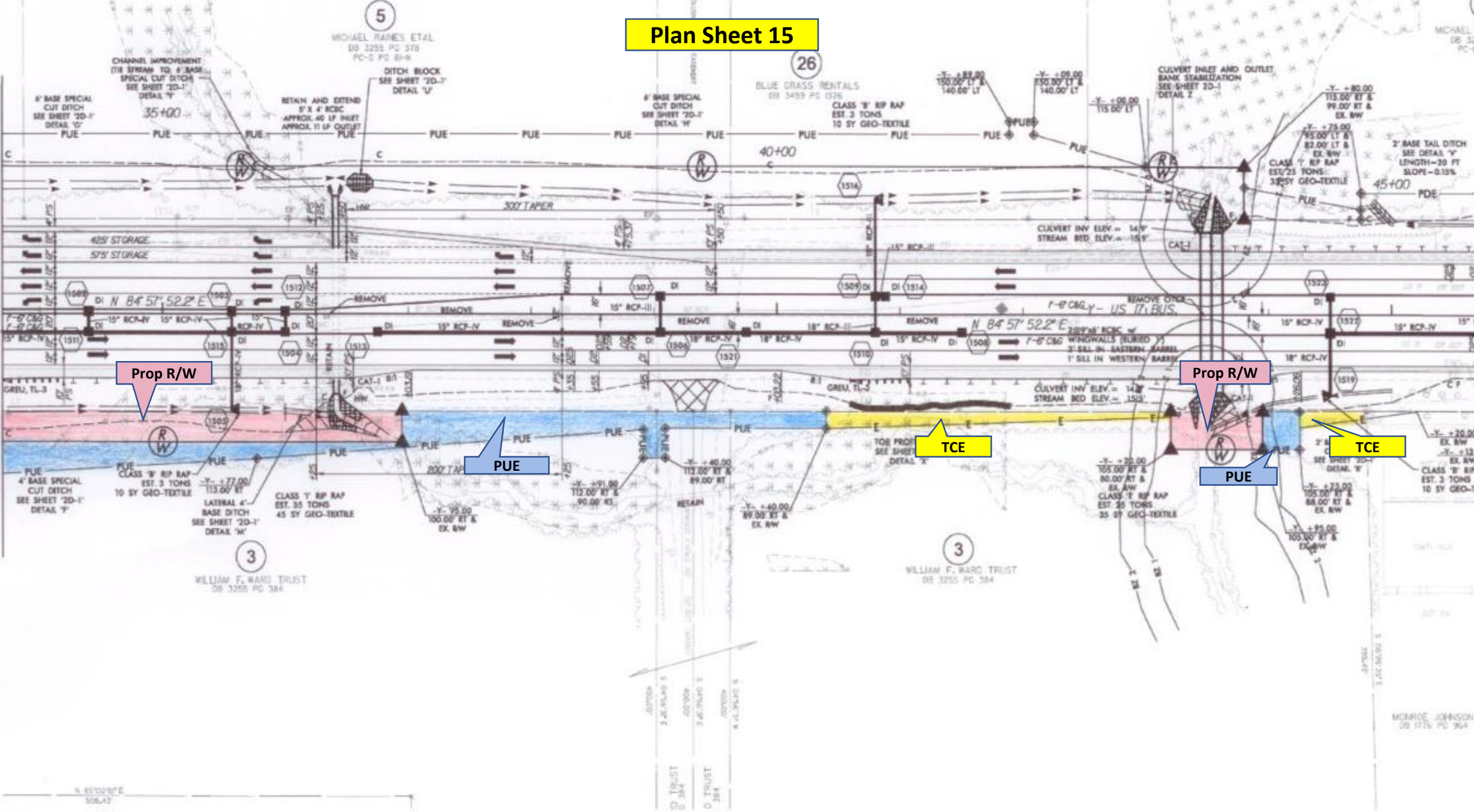

Prop R/W

PUE

TCE

Prop R/W

PUE

TCE

N 85°00'00"E
506.43

0.007009
3.4676640 S
0.007009
3.4676640 S
0.007009
3.4676640 S
0.007009
3.4676640 S

MORRIS JOHNSON
DB 1776 PG 964